

| | | | | |
|-------|------------------|------|-----------|---------|
| RevNo | Revision note | Date | Signature | Checked |
| 0 | GENERAL REVISION | | IP | IP |

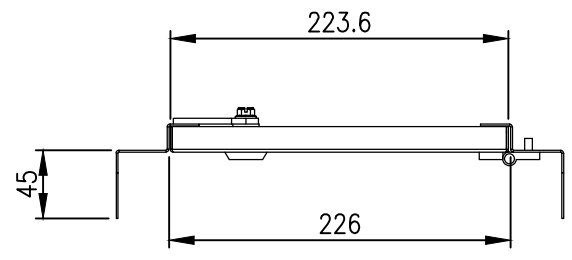

TOP VIEW

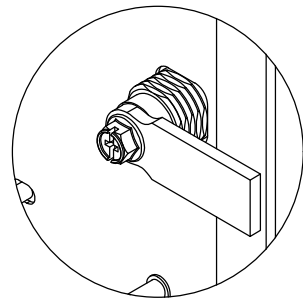

LOCKSET SPOT DETAIL

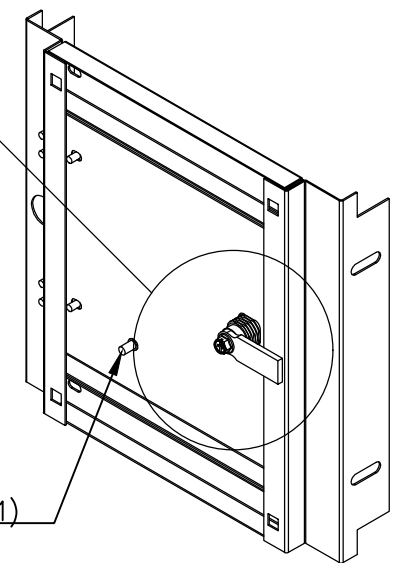

M6x10 STUD WELD (x1)

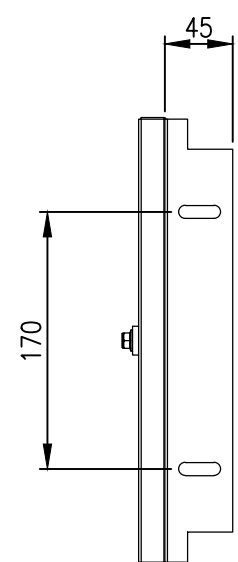

LEFT SIDE VERTICAL FRAME

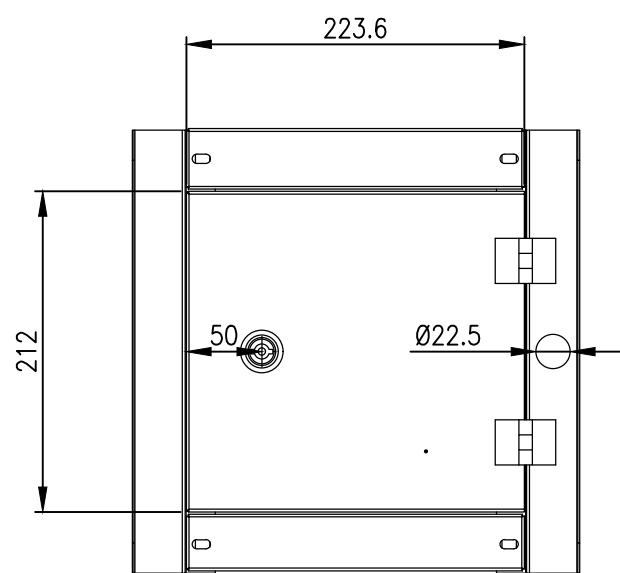

FRONT VIEW

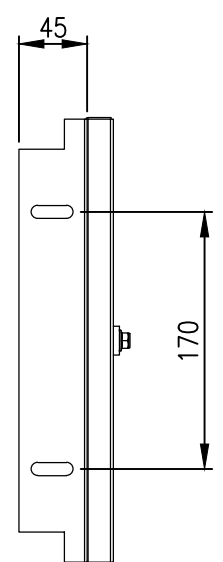

RIGHT SIDE VERTICAL FRAME

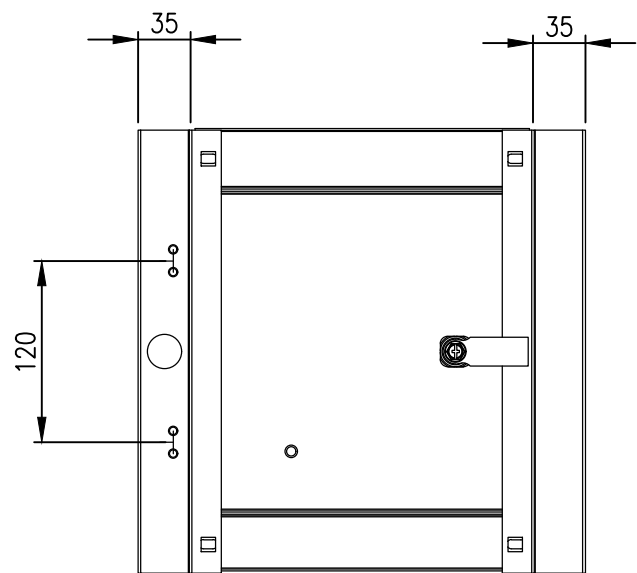

REAR VIEW

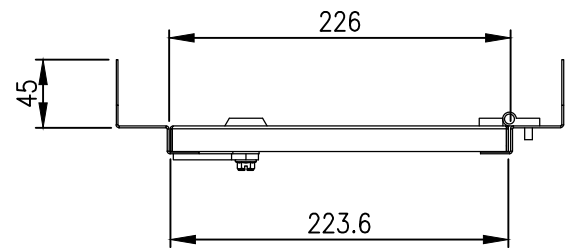
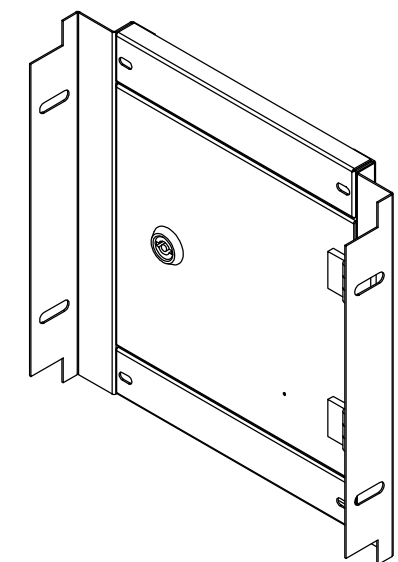

BOTTOM VIEW

MATERIAL
 FRAME: 1.5mm 316 STAINLESS STEEL
 DOOR PANEL: 1.5mm 316 STAINLESS STEEL

CLEARANCE/DISTANCE DIMENSIONS:
 -INNER DOOR TO OUTER DOOR: 68mm
 -INNER DOOR TO MOUNTING PLATE:
 -(ENCLOSURE WITH 150 DEPTH): 67.2mm
 -(ENCLOSURE WITH 200 DEPTH): 117.2mm

© IP ENCLOSURES 2022.
 THIS DRAWING SHALL NOT BE COPIED OR REPRODUCED
 WITHOUT AUTHORISATION FROM IP ENCLOSURES.
 www.ipenclosures.com.au

| | | | |
|-------------|------------|--|-----------------------|
| Itemref | Quantity | Title/Name, designation, material, dimension etc | Article No./Reference |
| IP | 1 | 300Hx300W 316SS INNER DOOR | IP-SSID3030 |
| Designed by | Checked by | Approved by - date | Filename |
| IP | IP | 04/07/22 | IP-SSID3030 |
| Date | Scale | Edition | |
| 04/07/22 | 1:5 | 0 | |
| Sheet | | | 1/1 |