

Electrical Enclosure Accessories IP-SSWINDOOR

TRANSPARENT DOORS | STAINLESS STEEL | IP66

IP Enclosures SSWINDOOR provide a range of stainless steel Transparent Glazed Doors that can be easily fitted to our range of electrical enclosures. Transparent Doors are provided as a standard accessory. Simply remove the existing door and replace with a transparent door.

Protection: IP66

Standard: IEC/EN 60529, RoHS



Material:

- Enclosure Door: 1.5mm grade 316L stainless steel
- Enclosure Seal: Polyurethane

Door: The surface mounted door is 1.5mm grade 316L stainless steel. It incorporates concealed removable hinges with captive pins. Doors are also designed for a 110° opening.

Seal: A high quality full perimeter seal provides excellent sealing over a long life. It is machine applied Polyurethane foamed in place (FIP).

Lock: Grade 316L stainless steel 8mm square drive quarter turn lock.



Image shown is for reference only. See table below for the accurate sizes and specifications.

Part Number	Enclosure Door Size	Glass Panel Size	Weight	Lock
SKU	H x W (mm)	X x Y (mm)	Kilogram (Kg)	Quantity (pc)
IP-SS4040WINDOOR	395H x 395W	204 x 204	2.5	1
IP-SS6040WINDOOR	595H x 395W	204 x 404	3.6	2
IP-SS6060WINDOOR	595H x 595W	404 x 404	5	2
IP-SS8080WINDOOR	795H x 795W	604 x 604	6.3	2

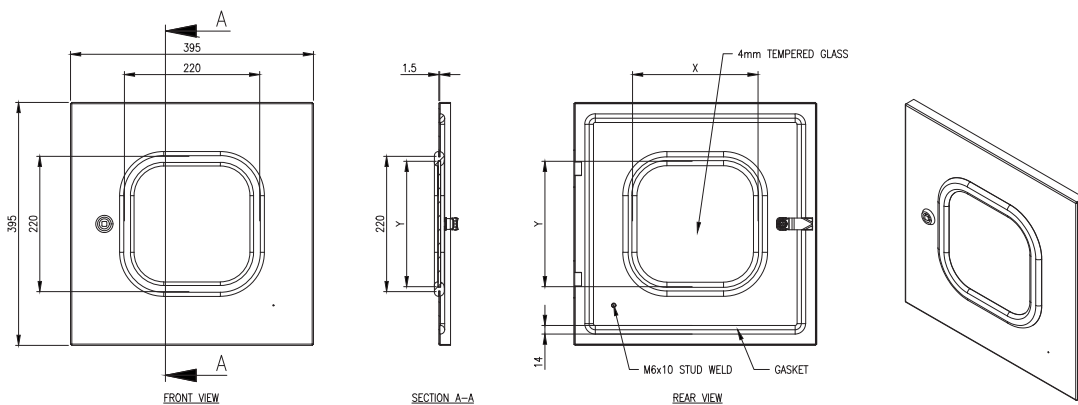

NOTE: 2D drawing is for reference only. See CAD files for sizes and specifications.