

TOP VIEW

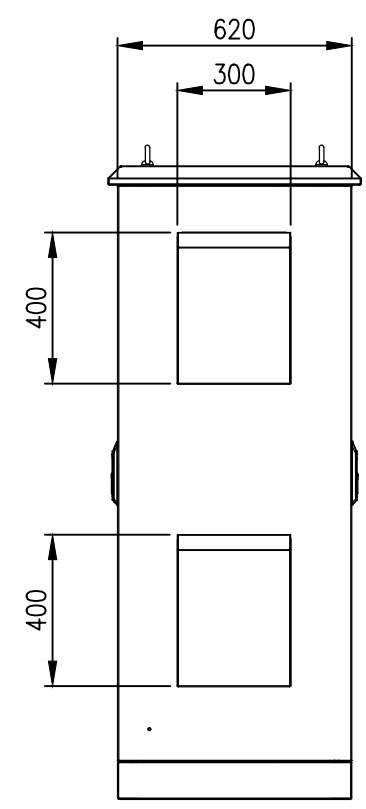

LEFT SIDE VIEW

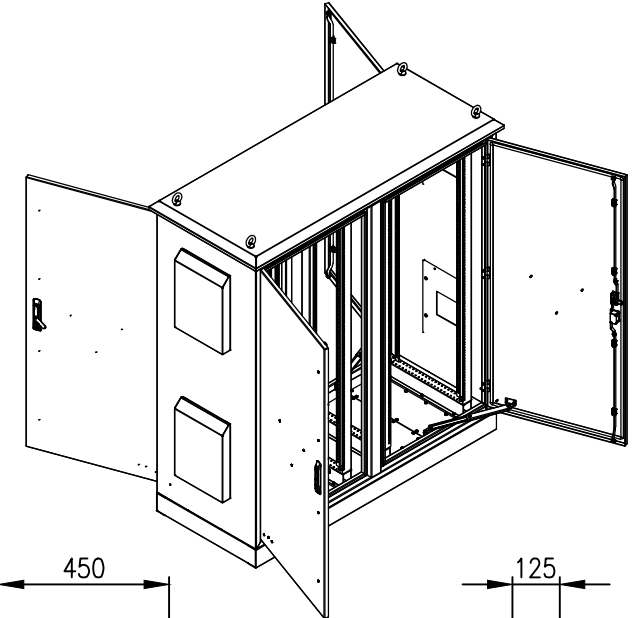
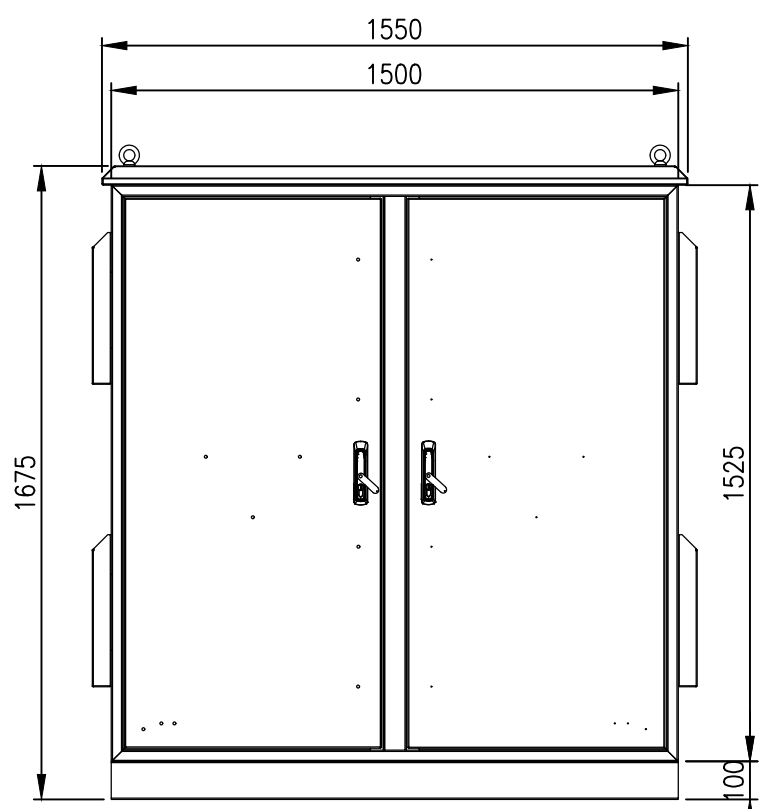

FRONT VIEW

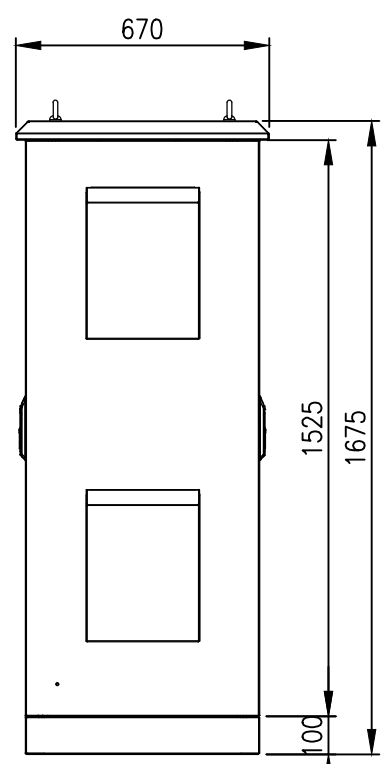

RIGHT SIDE VIEW

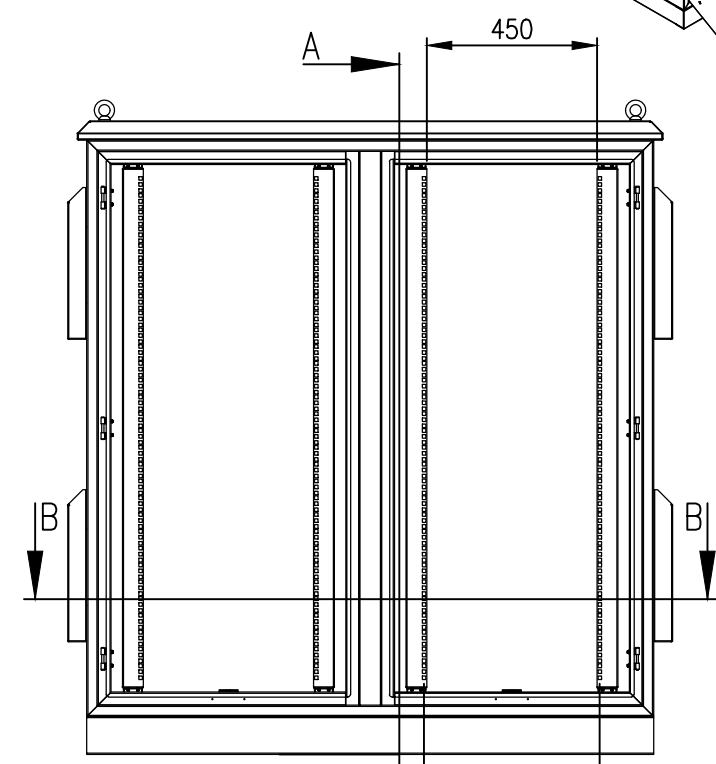

INTERIOR VIEW-DOOR REMOVED

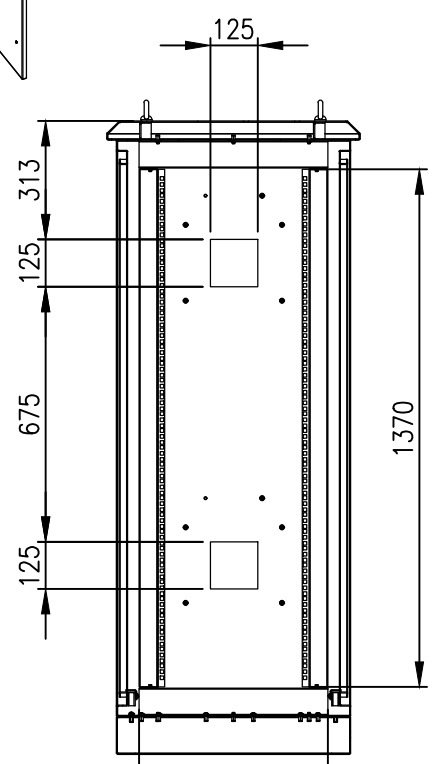

SECTION A-A

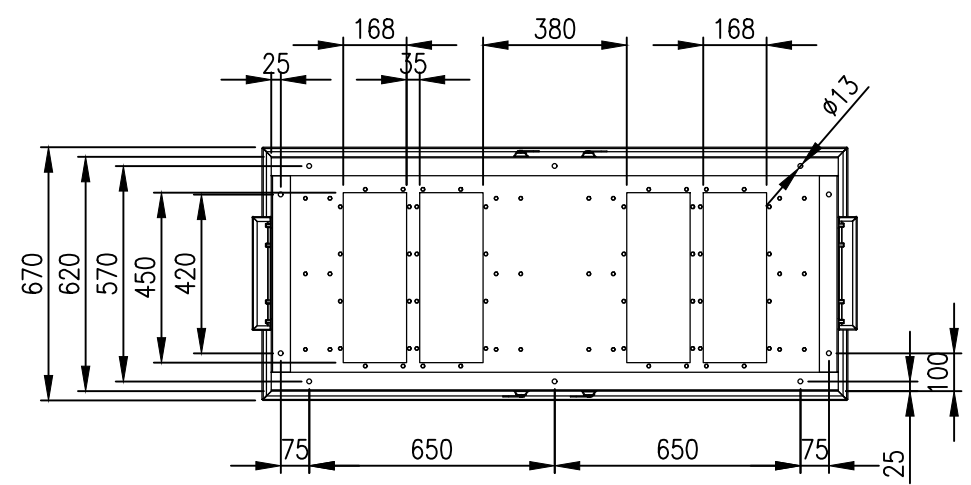

BOTTOM VIEW

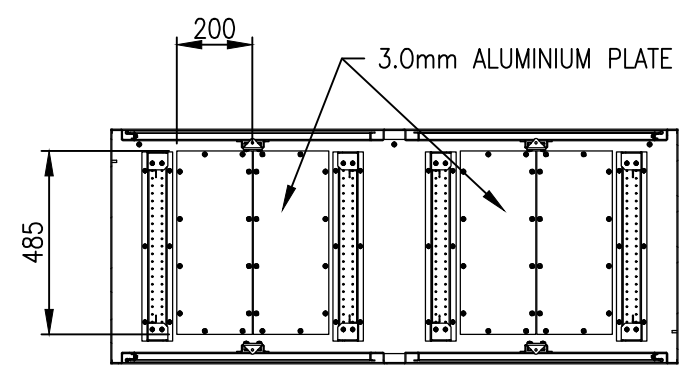

SECTION B-B

**MATERIAL**  
 BODY AND PLINTH: 2.5mm MARINE GRADE ALUMINIUM 5754-H111  
 DOORS: 2.5mm MARINE GRADE ALUMINIUM 5754-H111  
 19" DATA RAILS: 1.5mm GALVANISED STEEL SHEET  
 GLAND PLATE: 3.0mm ALUMINIUM  
 SEAL: POLYURETHANE  
 SURFACE TREATMENT: POWDER-COAT 80-120micron  
 COLOUR: T33 SMOKE BLUE, SMOOTH FINISH

PROTECTION: IP55  
 STANDARD: IEC62208, IEC/EN/AS60529, EIA-310D

© IP ENCLOSURES 2024.  
 THIS DRAWING SHALL NOT BE COPIED OR REPRODUCED  
 WITHOUT AUTHORISATION FROM IP ENCLOSURES.  
 www.ipenclosures.com.au

Itemref	Quantity	Title/Name, designation, material, dimension etc	Article No./Reference
Designed by IP	Checked by IP	Approved by - date 01/02/24	Filename IP-A16715062-T33
		Date 01/02/24	Scale 1:20
			2 x 30RU (60RU) ALUMINIUM FIELD CABINET 1675Hx1500Wx620D DOUBLE BAY IP-A16715062-T33
			Edition 0
			Sheet 1/1